

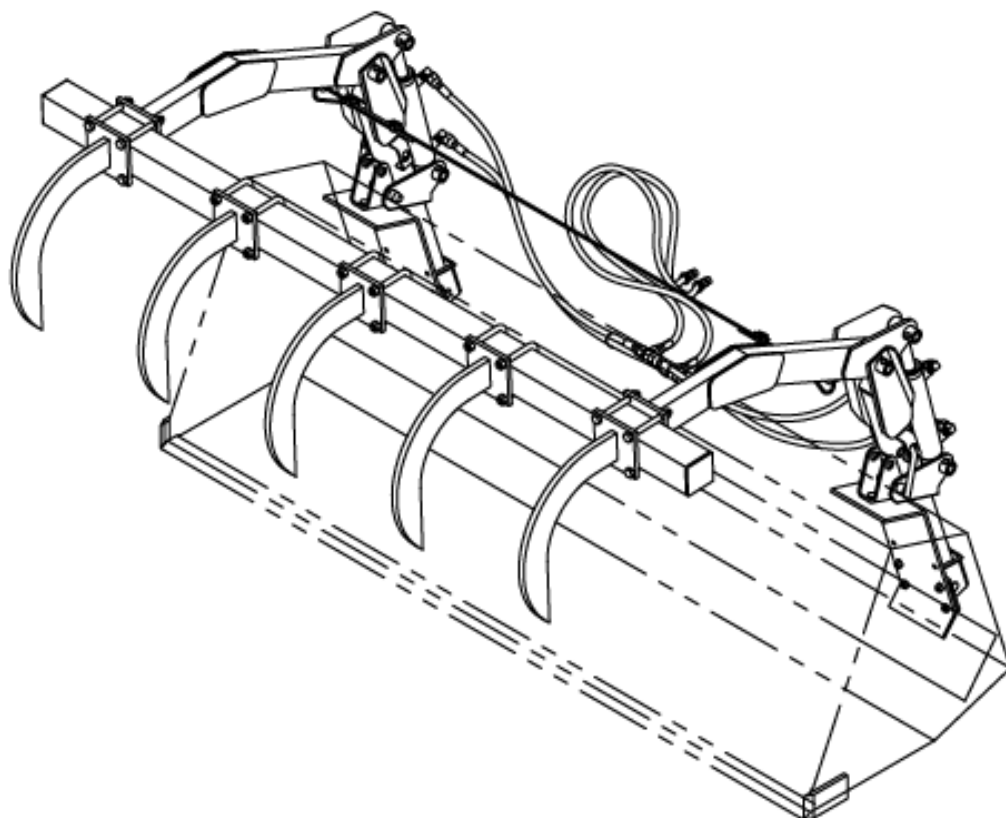

# OPERATOR AND PARTS MANUAL

## Quick-Tach Grapple

Model C2000





## Table of Contents

<b>Introduction .....</b>	<b>4</b>
<b>Safety.....</b>	<b>5</b>
• Safety .....	5
• General Safety .....	6
• Start-up Safety .....	6
• Operation Safety .....	6
• Transport Safety .....	7
• Service and Maintenance Safety .....	7
• Storage Safety .....	7
• Safety Signs .....	8
• Safety Sign Installation .....	8
<b>Mounting.....</b>	<b>9</b>
<b>Assembly.....</b>	<b>10</b>
<b>Parts .....</b>	<b>11</b>
<b>Grapple Hydraulic Kits .....</b>	<b>12</b>
<b>Recommended Mounting Dimensions.....</b>	<b>12</b>
• Standard Buckets .....	12
• 85" Manure Bucket.....	13
<b>Clamp and Cable Information.....</b>	<b>13</b>
<b>Grapple Removal/Attachment .....</b>	<b>14</b>
<b>Troubleshooting.....</b>	<b>15</b>
<b>Important Precautions .....</b>	<b>16</b>
<b>Hydraulic Cylinder Assembly .....</b>	<b>18</b>
<b>Warranty .....</b>	<b>20</b>

**Manufacturer's statement:** for technical reasons Buhler Industries Inc. reserves the right to modify machinery design and specifications provided herein without any preliminary notice. Information provided herein is of descriptive nature. Performance quality may depend on soil fertility, applied agricultural techniques, weather conditions and other factors.

## Introduction

---

Allied builds rugged attachments for all your commercial needs. Whether you need a skid steer or tractor configuration, Allied makes all large jobs easier. Products range from commercial grade snow blades to hay handling forks and grapples.

Attachments are coated with a three-part paint process to ensure many years of maintenance free service. Allied loader attachments can be fixated to any loader or skid steer model currently on the market. Simplicity and ease of use have been built into Allied for many years. Join in the tradition of quality Allied products and have them working for your operation today.

Keep this manual handy for frequent reference. All new operators or owners must review the manual before using the equipment and at least annually thereafter. Contact your Allied Dealer if you need assistance, information, or additional copies of the manual. Visit our website at [www.buhlerindustries.com](http://www.buhlerindustries.com) for a complete list of dealers in your area.

The directions left, right, front and rear, as mentioned throughout this manual, are as seen facing in the direction of travel of the implement.

## Safety

### Safety Instructions

Remember, YOU are the key to safety. Good safety practices not only protect you, but also the people around you. Make these practices a working part of your safety program. Be certain that everyone operating this equipment is familiar with the recommended operating and maintenance procedures and follows all the safety precautions. Most accidents can be prevented. Do not risk injury or death by ignoring good safety practices.

The alert symbol is used throughout this manual. It indicates attention is required and identifies hazards. Follow the recommended precautions.



The safety alert symbol means...

**ATTENTION! BECOME ALERT! YOUR SAFETY IS INVOLVED!**



#### CAUTION

The caution symbol indicates a potentially hazardous situation that, if not avoided, may result in minor or moderate injury. It may also be used to alert against unsafe practices.



#### WARNING

The Warning Symbol indicates a potentially hazardous situation that, if not avoided, could result in death or serious injury, and includes hazards that are exposed when guards are removed. It may also be used to alert against unsafe practices.



#### DANGER

The Danger Symbol indicates an imminently hazardous situation that, if not avoided will result in death or serious injury. This signal word is to be limited to the most extreme situations, typically for machine components that, for functional purposes, cannot be guarded.

## General Safety Instructions

- Have a first-aid kit available for use and know how to use it.
- Have a fire extinguisher available, stored in a highly visible location, and know how to use it.
- Wear appropriate protective gear. This list may include but is not limited to:
  - hard hat
  - protective shoes with slip resistant soles
  - protective glasses or goggles
  - heavy gloves
  - wet weather gear
  - hearing protection
  - respirator or filter mask
- Read and understand the Operator's Manual and all safety signs before operating, servicing, adjusting, repairing, or unplugging the equipment.
- Do not attempt any unauthorized modifications to your Allied product as this could affect function or safety, and could affect the life of the equipment.
- Inspect and clean the working area before operating.
- Keep hands, feet, clothing, and hair away from moving parts.
- Ensure bystanders are clear of the area before operating.
- Improper use of the loader and tractor can cause serious injury or death.

## Start-Up Safety

- Do not let inexperienced operators or children run this equipment.
- Place all tractor and machine controls in neutral before starting.

## Operation Safety

- Do not permit riders.
- Do not wear loose fitting clothing during operation.
- Operate the loader while seated in the tractor seat only.
- Never leave the tractor unattended while the attachment is raised. Always lower the attachment to ground and shut the tractor off before leaving the tractor seat.
- Never work beneath a raised loader unless it is securely supported. The control lever can be moved or a hydraulic leak could cause the loader to drop resulting in serious injury or death. Refer to the Lift Lock Instructions Decal for proper use of the lift locks.
- Prior to use, check to ensure the attachment is properly locked to the quick-tach. Verify from tractor seat by lowering the attachment to ground and retracting the lift cylinders.
- Never operate the loader with frayed or damaged hoses or leaking fittings. A burst could cause the loader to drop suddenly and result in serious injury or death and cause damage to the loader or tractor.
- Keep tractor on solid ground. Loose fill, rocks and holes can be dangerous for loader operation and movement.
- A pivoting front axle acts like a three-wheeled tractor until the stops hit the axle.
- Space rear tires as recommended by the tractor manufacturer. Maximize width for high lift applications and uneven terrain.
- Add rear ballast as required to ensure 25% of gross vehicle weight is transferred to the rear axle. Loader, attachment and payload must be included as weight.

- Do not raise attachment to extreme heights while tractor is on an incline. Be alert for terrain changes and adjust accordingly. Keep attachment at low travel height, no more than one foot, as long as possible.

## Transport Safety

- Review Transport Safety instructions in tractor manual before moving.
- Check with local authorities regarding transport on public roads. Obey all applicable laws and regulations.
- Make sure the SMV (Slow Moving Vehicle) emblem and all the lights and reflectors that are required by the local highway and transport authorities are in place, are clean, and can be seen clearly by all overtaking and oncoming traffic.
- Never have the equipment in operation during transport.
- Always travel at a safe speed.
- Allow for attachment and loader length when turning.
- The tractor must be equipped with an approved Roll Over Protection Structure (ROPS) and safety belts.

## Service and Maintenance Safety

- Stop engine, set brake, remove ignition key, and wait for all moving parts to stop before servicing, adjusting, repairing, or unplugging.
- Support the equipment with blocks or safety stands before working beneath it.
- Follow good shop practices including:
  - keep service area clean and dry
  - be sure electrical outlets and tools are properly grounded
  - use adequate light for the job.
- Use only tools, jacks, and hoists of sufficient capacity for the job.
- Replace and secure all shields removed during servicing before operating.
- Use heavy leather gloves to handle sharp objects.
- Check hydraulics regularly for leaks. Use cardboard to look for leaks, and use hand and eye protection.
- Relieve pressure on hydraulic system before repairing or adjusting.

## Storage Safety

- Store the unit in an area away from human activity.
- Do not permit children to play on or around the stored machine.
- Support the frame on stands and blocks to provide a secure base.

## Safety Signs

- Keep all safety signs clean and legible and replace any that are damaged or missing.
- When original parts are replaced, any safety signs affixed to those parts should be replaced as well. Replacement safety signs are available from your local dealer.

## Installation

- To install safety signs, ensure the installation area is clean and dry. Decide on the exact position before you remove the backing paper. Remove the smallest portion of the split backing paper and align over the specified area. Carefully press in place.
- Slowly peel back the remaining paper and smooth the remaining portion in place. Small air pockets can be pierced with a pin and smoothed out.
- Replace safety signs immediately should they become damaged, torn or illegible. Obtain replacements from your authorized dealer using the part numbers shown.



## Mounting

Please read and understand the following instructions before mounting.

1. Refer to the recommended mounting dimensions for mounting hole locations on various loader/bucket combinations. Drill twelve 0.56" diameter holes as indicated. Drill two 0.44" diameter holes into the top of the bucket for the hose clamps. Proper position of the hose clamps will eliminate interference between the hoses and mechanical linkages during loader operation. Specific grapple buckets equipped with backing plates and prepunched holes are also available. See price pages or contact local dealer.
2. Install the quick-tach brackets (item 7, 31), grapple boots (item 6), and backing plates (item 8, 32) onto the bucket with carriage bolts (item 24) and steel lock nuts (item 27). Finger tighten hardware. **NOTE:** backing plates must be adapted for all 'X' Series buckets as shown.
3. Install uprights (item 4) into boots and brackets with quick-tach pins (item 9) and hair pin clips (item 10). Assemble mainframes (item 3) into the uprights using pins (item 13), bolts (item 23) and nylon lock nuts (item 26).
4. Support mainframes and install hydraulic cylinders using pins (item 14), bolts (item 23) and nylon lock nuts (item 26).
5. Assemble elbows (item 17), 44" hoses (item 16), tees (item 18), 72" hoses (item 15) and hydraulic tips (item 19). Connect hoses to grapple hydraulic kit. Clamp hoses to the top of the bucket using clamps (item 36), plates (item 35), bolts (item 37), and nuts (item 34). Tyrops (item 20) have been provided to group hoses. Ensure sufficient clearance during operation.
6. Using bolts (item 22) and steel lock nuts (item 25), assemble the outer tooth weldments (item 1) and the cross tube (item 2) to the mainframes as shown. Torque bolts to 150 ft-lbs.
7. Adjust the quick-tach bracket and boot locations such that the quick-tach pins can be removed and installed by hand. Slots have been provided for adjustment. Torque bolts to 75 ft-lbs.
8. Attach remaining teeth (item 1) to the cross tube (item 2) using u-bolts (item 21) and steel lock nuts (item 25). Position teeth as required. Avoid interferences with bucket tines (if equipped). Torque bolts to 150 ft-lbs.
9. Attach the cable (item 11) to the mainframe using cable clamps (item 12). See clamp and cable information for proper assembly.
10. Apply grease to all pivots as indicated by grease symbols.
11. Completely raise and lower the loader and fully dump and rollback the bucket while the grapple remains in an opened and closed position. Ensure that the loader and grapple operate properly. Verify that all hoses are routed and tied appropriately to avoid rubbing or pinching during operation.

## Assembly

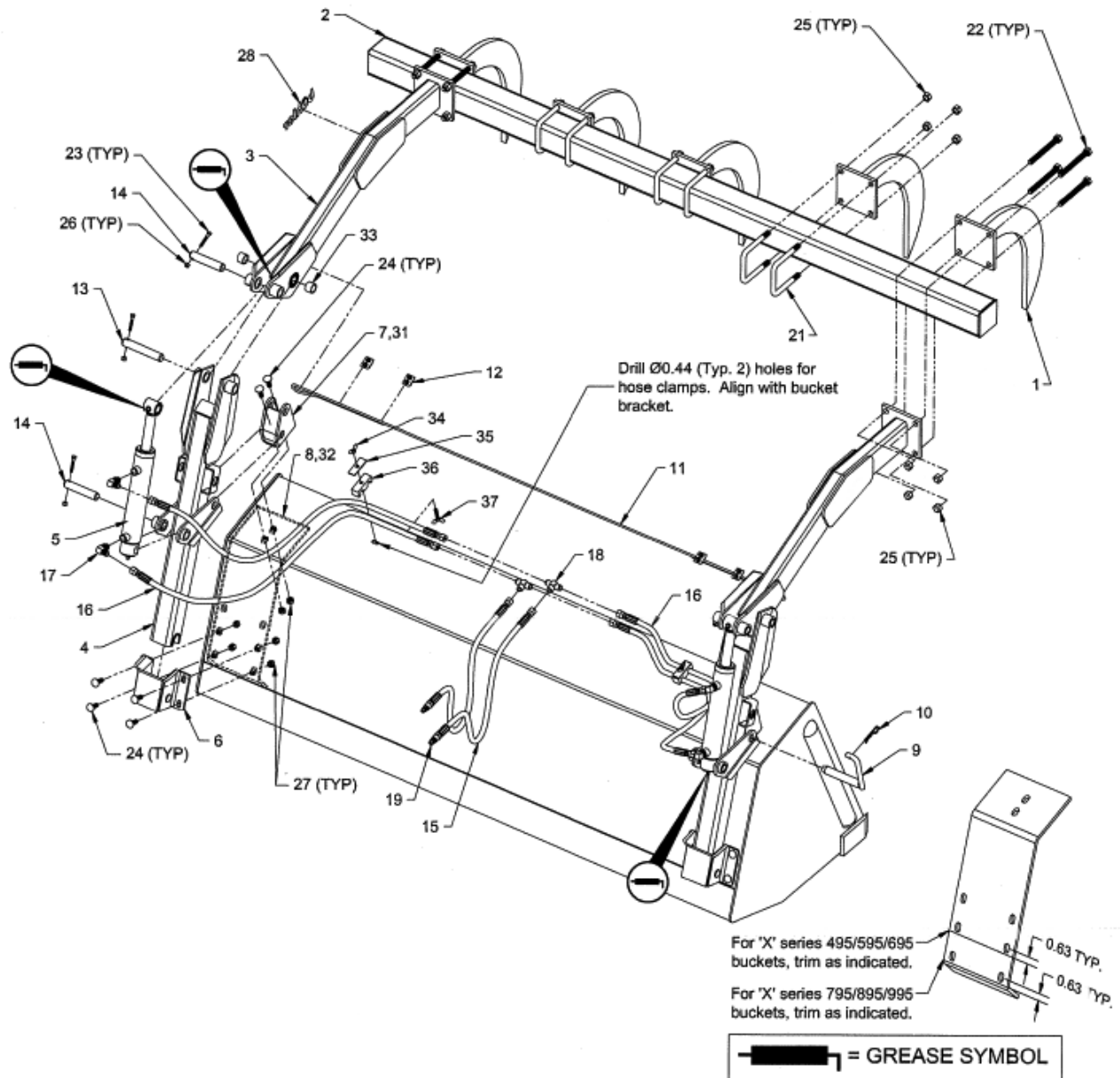

### NOTE:

1. Item 20, ty-raps, are to be used to hold hoses together.
2. Item 29, dust caps, are to be attached to the male hydraulic tip.
3. Item 30, cylinder decals, are to be placed on the tube weldments.
4. Standard bucket assembly shown.

## Parts

Item	Part No.	Description	Standard Bucket C2000 (84")	Manure Bucket C2062 (84")	Tine Kit X1999
1	114408	Tooth Weldment	5	5	1
2	114467	Cross Tube 84"	1	1	
	114793	Cross Tube 96"			
3	24755	Mainframe Weldment	2	2	
4	24756	Upright Weldment	2	2	
5	24875	Cylinder Assembly 2.5 x 7.25	2	2	
6	114723	Grapple Boot Weldment	2	2	
7	114427	Quick-Tach Weldment	2		
8	115551	Backing Plate	2		
9	114741	Quick-Tach Pin Weldment	2	2	
10	12779	Hair Pin Clip	2	2	
11	114880	Cable 0.250 dia GAC 7 x 19	1	1	
12	961658	Clamp Cable 1/4"	4	4	
13	104719	Pin 1.00 dia x 6.00 long	2	2	
14	113797	Pin 1.00 dia x 5.00 long	4	4	
15	811579	3/8 x 72 Hose 3/4 MORB x 3/4 SWFJIC	2	2	
16	115635	3/8 x 50 Hose 3/4 SWFJIC x 3/4 SWFJIC	4	4	
17	811414	Elbow 90 3/4 MORB x 3/4 MJIC	4	4	
18	812069	Tee 3/4 MJIC	2	2	
19	812841	Coupler Male 0.75 ORB	2	2	
20	812075	Ty-Rap 13-5/8" long (TY-27M)	4	4	
21	112988	U-Bolt 0.63 x 4.06 x 5.25	6	6	2
22	812087	Bolt Hex 0.625nc x 6.00 gr5 pl	8	8	
23	810640	Bolt Hex 0.313nc x 2.00 gr5 pl	6	6	
24	812217	Bolt Carriage 0.500nc x 1.50 gr5 pl	12	12	
25	812482	Nut Lock (Steel) 0.625nc grB pl	20	20	4
26	84541	Nut Lock (Nylon) 0.313nc grB pl	6	6	
27	812364	Nut Lock (Steel) 0.500nc grB pl	12	12	
28	815034	Allied by Farm King Decal	2	2	
29	813305	Dust Cap – Black	2	2	
30	22370	Hydraulic Cylinder Decal	2	2	
31	114900	Quick-Tach Weldment (manure bucket)		2	
32	114904	Backing Plate (manure bucket)		2	
33	114430	Bushing 1.0 I.D. x 1.25 O.D. x 0.88 LG	4	4	
34	84217	Nut Wing 0.375nc gr2 pl	2	2	
35	113923	Hose Clamp Plate	2	2	
36	113843	3/8 Hose Clamp (Poly)	2	2	
37	813471	Wing Screw 0.375nc x 2.00 gr5 pl	2	2	

## Grapple Hydraulic Kits

Part No.	Description
C9936	495-895 REG/HSL
C1964	595-795 TSL
C1965	895 TSL
C2246	2595/2596/2795

### NOTE:

Grapple hydraulic kits are sold separately. Kits include hydraulic tubes, which are mounted along existing loader hydraulic tubes for grapple operation, hydraulic couplers and hardware.

## Recommended Mounting Dimensions

### Standard Buckets

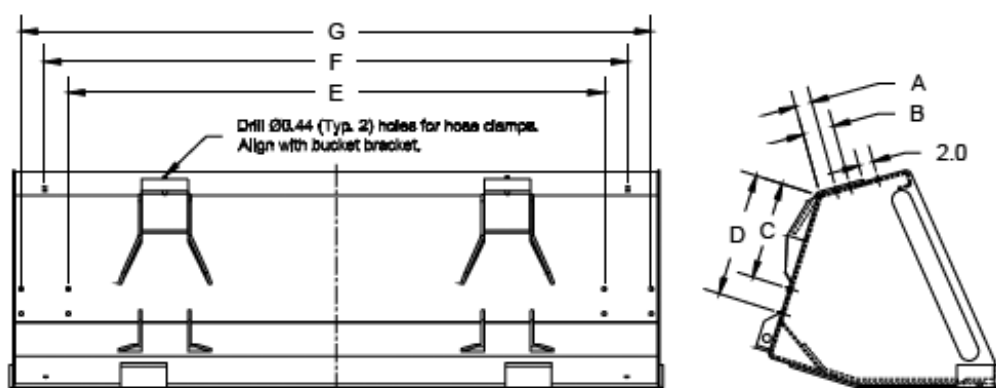

Loader Model	495/595/695/2495/2595		795/2795/895/2895/995			Any	
Bucket Series	'X' Series		'X' or 'B' Series			'B' Series	
Bucket Width	72"*	84"	72"*	84"	96"*/102"*	84"	96"*/102"*
A	2.25	2.25	2.38	2.38	2.38	2.38	2.38
B	4.13	4.13	4.25	4.25	4.25	4.25	4.25
C	9.50	9.50	12.56	12.56	12.56	12.56	12.56
D	13.00	13.00	16.06	16.06	16.06	16.06	16.06
E	57.63	65.63	57.63	65.63	69.63	65.63	69.63
F	63.75	71.75	63.75	71.75	75.75	71.75	75.75
G	69.88	77.88	69.88	77.88	81.88	77.88	81.88

### NOTE:

- The above table lists the recommended hole spacing for all Allied loaders from 495 to 995 (including Reg/S/HSL/TSL) with standard buckets. If required the grapple may be located to suit specific applications. Verify all clearances between the grapple and the loader.
- When used with Allied standard buckets, dimensions A, B, C, and D must be kept as specified in the table.
- The minimum cross tube length (84") will extend 6" past both ends of the 72" buckets.
- Grapple buckets (B459584, B479584, B479596, B489596, B4259584 and B4279596) come equipped with backing plates and pre-punched holes.

\*This mounting combination may not allow the bucket quick-tach pin to be placed in the quick-tach storage location. This does not affect the ability to install or remove the quick-tach bucket.

## 85" Manure Bucket

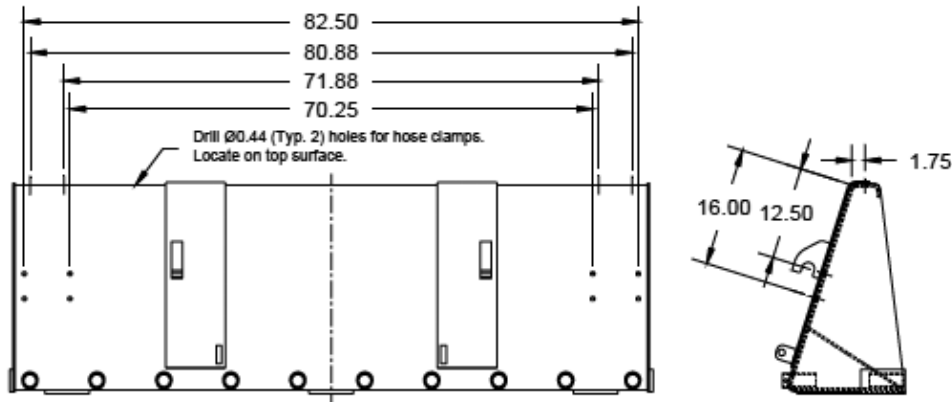

### NOTE:

1. Recommended grapple spacing for an 85" manure bucket. If required the grapple may be located to suit specific applications. Verify all clearances between the grapple and the loader.
2. Grapple cannot be mounted as shown on 49" and 67" manure buckets. Mount inside quick-tach brackets if desired.

## Clamp and Cable Information



### NOTE:

1. Nominal breaking strength of 1/4" 7 x 9 Galvanized Aircraft Cable: 7000 lbs.
2. Do not reinstall used clamps.
3. Re-tighten nuts periodically after cable has been in use. Torque to 15 ft-lbs.
4. Do not lubricate threads.
5. Never use clips to make direct end-to-end joints of rope.
6. Saddle of clamps must always be installed at long (live) end of cable.

## Grapple Removal/Attachment

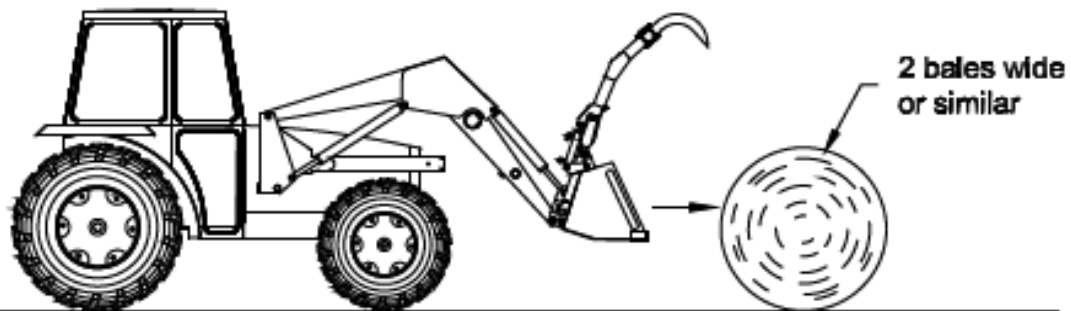

Figure 1

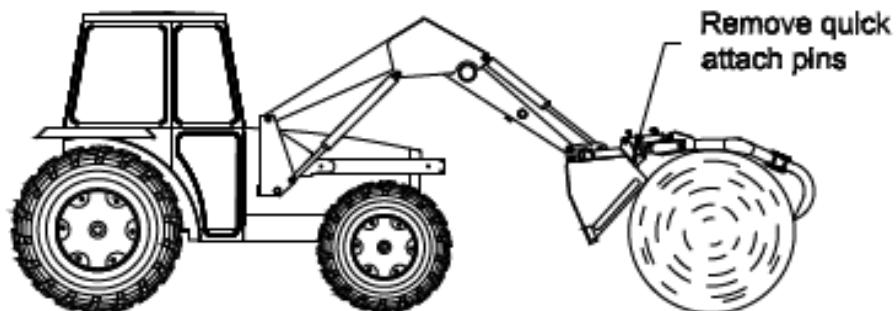

Figure 2

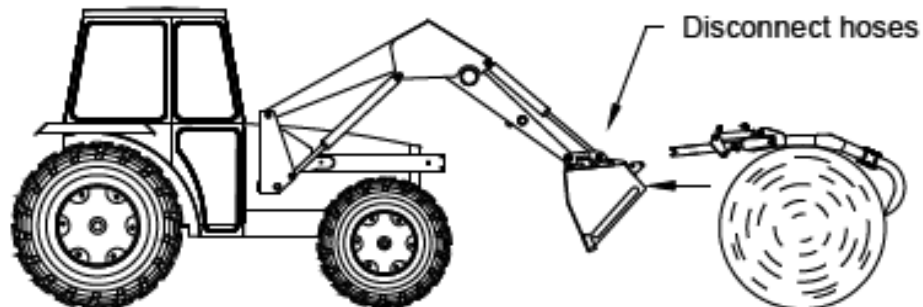

Figure 3

**NOTE:**

1. With grapple open, approach two bales placed end to end (Figure 1).
2. Position grapple over bales as shown (Figure 2).
3. Remove both quick attach pins.
4. Back out slowly. Grapple will slide out of mount bracket weldments (Figure 3.)
5. Disconnect hoses.
6. To reattach, reverse process

## Troubleshooting

Problem	Cause	Remedy
Loader slow and/or will not dump	Quick couplers leaking	Check connections and compatibility or replace
	Hydraulic oil too heavy	Change or replace filter
	Oil filter plugged	Clean or replace filter
	Hydraulic pump worn	Repair or replace pump
	Oil line restricted or leaking	Check all hoses and tubes for leaks, damage or restrictions. Replace damaged or restricted hoses or tube lines.
	Control valve does not shift properly	Inspect, clean, repair or replace valve
	Air in hydraulic system	Cycle lift cylinders and bucket cylinders several times to free system of air
	Cylinder leaks internally	Replace seals
	Faulty valve	Repair or replace valve
Loader chatters or vibrates when raising and lowering  Excessive movement at pivots	Air leak in pump inlet line.	Check, tighten or replace inlet line
	Air in hydraulic system	Cycle lift cylinders and bucket cylinders.
	Oil level too low	Add oil as required
	Worn bushings and/or pins	Replace bushings and/or pins
Pump noisy	Inlet line restricted or leaking.	Check for air leaks, restrictions or collapsed hose. Tighten or replace hose. Clean filter if necessary.
	Oil level too low	Add oil as required
	Pump worn or damaged	Repair or replace pump
Insufficient lift capacity	Improper hydraulic pump operation	Repair or replace pump
	Load is greater than boom lift capacity	Check loader specifications
	Internal boom cylinder leakage	Replace any worn parts and install a seal repair kit
	Improper hydraulic valve operation	Repair or replace valve
Slow leak down	Worn control valve	Have authorized dealer replace seals
	Worn cylinder piston seals	Have authorized dealer replace seals
Excessive wear on bottom of bucket and wear pads	Float position not used while operating loader	Use float position provided on valve.
Hydraulic cylinders. Inoperative	Hose from control valve improperly connected	Refer to plumbing diagrams.
Pump operating continually on closed center tractor hydraulic system	Tractor control valve relief stuck open	See your tractor manual for proper adjustment or loader dealer for loader valve. (3000 PSI is maximum pressure relief setting recommended.)
	Hydraulic control valve set too low.	Adjust valve in accordance with manual.
Loaders lift and bucket tilt controls do not work according to decal	Hoses improperly connected.	Replace relief valve with closed center plug and plug the power beyond adapter on valve.
Valve noise and/or hot	Open center control valve on closed center tractor	Replace relief valve with closed center plug and plug the power beyond adapter on valve.
Tractor loads/pump squeals.	Closed center control valve on open center tractor	Install open center plug on optional valve. Replace closed center plug with relief and install short plug in place of power beyond adapter

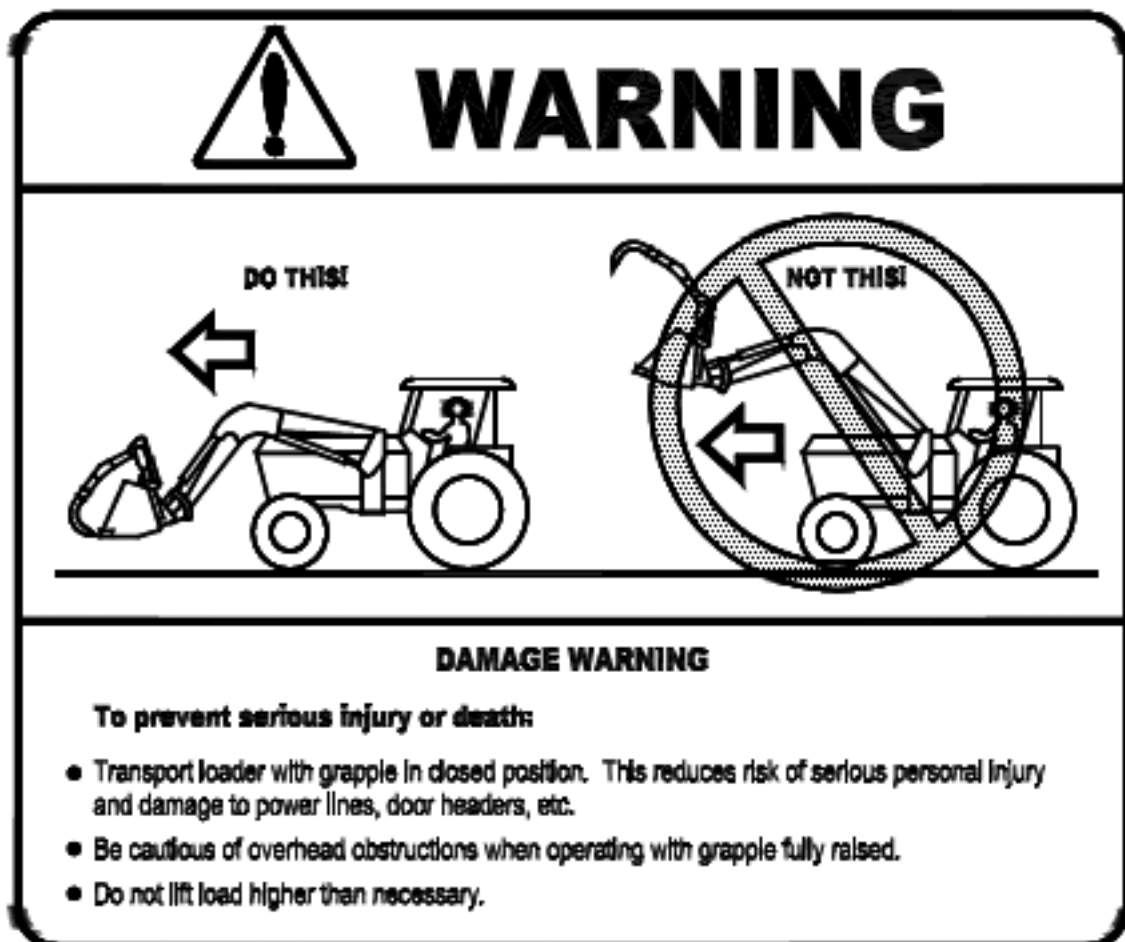

## Important Precautions

The following pictorials indicate important precautions to be used during the operation of the loader and grapple.





**⚠ DANGER**

**ELECTROCUTION HAZARD**  
To prevent serious injury or death:

Stay away from power lines and cables.  
Electrocution can occur with or without direct contact.

**⚠ WARNING**



**FALLING HAZARD**  
To prevent serious injury or death:

Do not lift, carry or allow anyone to ride on or work from any portion of loader.



**⚠ WARNING**



**CRUSHING HAZARD**  
To prevent serious injury or death:

Do not handle round bales or other shiftable objects unless loader is equipped with an attachment designed for this purpose.  
Do not handle loose loads that are not secured.  
Do not lift load higher than necessary.

**⚠ WARNING**

**HIGH PRESSURE FLUID**  
To prevent serious injury or death:

Relieve pressure on system before repairing or adjusting or disconnecting.  
Wear proper hand and eye protection when searching for leaks. Use wood or cardboard instead of hands.  
Keep all components in good repair.  
If hydraulic fluid penetrates skin, obtain medical treatment IMMEDIATELY.

**⚠ WARNING**



**ROLL-OVER HAZARD**  
To prevent serious injury or death:

Move and turn tractor at low speed.  
Carry load no higher than necessary to clear the ground when transporting.  
Add wheel ballast or rear weight for stability.  
Move wheels to widest possible settings to increase stability.  
It is recommended the tractor be equipped with a rollover protective structure (ROPS).

**⚠ WARNING**



**CRUSHING HAZARD**  
To prevent serious injury or death:

Do not allow bystanders in loader work area.  
Lower loader to the ground before leaving seat.  
Do not walk or work under raised loader. For servicing, refer to operator's manual.  
Read and understand operator's manual before operating loader.

## Hydraulic Cylinder Assembly

24758	24875	Cylinder Assembly
2.00"	2.50"	Diameter
7.25"	7.25"	Length of Stroke
16.50"	16.50"	Retracted Length
23.75"	23.75"	Extended Length
X1348	X1110	Seal Kit No.
1.25"	1.50"	Shaft Diameter

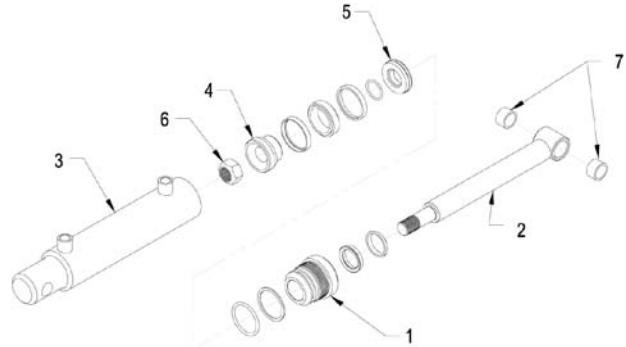

Item	Part No.	Part No.	Description
1	24516	24540	Head Plate
2	114411	24874	Shaft Weldment
3	24757	24873	Cylinder Tube Weldment
4	114520	113217	Piston Half (wide)
5	114521	113216	Piston Half (narrow)
6	812655	813407	Self-Locking Nut
7	114430	114430	Shaft Bushing

### NOTE:

1. Cylinders may vary in appearance.
2. All cylinder seals are contained in corresponding seal kit.
3. Cylinder assembly no. 24875 (2.5 Dia.) supplied as standard.



### **CAUTION**

Maximum pressure - 3000 psi



## Allied by Farm King Limited Warranty

This document limits your warranty rights.

### Base Limited Warranty

Buhler Industries Inc. provides this warranty only to original retail purchasers of its product. Buhler Industries Inc. warrants to such purchasers that all Buhler Industries Inc. manufactured parts and components used and serviced as provided for in the Operator's Manual shall be free from defects in materials and workmanship for a period following delivery to the original retail purchaser of 12 months (80 days for commercial applications). This limited warranty applies only to those parts and components manufactured by Buhler Industries Inc. Parts and components manufactured by others are subject to their manufacturer's warranties, if any.

Buhler Industries Inc. will fulfill this limited warranty by, at its option, repairing or replacing any covered part that is defective or is the result of improper workmanship, provided that the part is returned to Buhler Industries Inc. within thirty (30) days of the date that such defect or improper workmanship is, or should have been, discovered. Buhler Industries Inc. reserves the right to either inspect the product at the buyer's location or have it returned to the factory for inspection. Parts must be returned through the selling representative and the buyer must prepay transportation charges.

Buhler Industries Inc. will not be responsible for repairs or replacements that are necessitated, in whole or part, by the use of parts not manufactured by or obtained from Buhler Industries Inc. Under no circumstances are component parts warranted against normal wear and tear. There is no warranty on product pump seals, product pump bearings, rubber product hoses, pressure gauges, or other components that require replacement as part of normal maintenance. Also: Buckets and Bucket Tines carry no warranty, Bent Spears carry no warranty, Snowblower Fan Shafts carry no warranty, Mower Blades carry no warranty, Portable Auger Parts Have Two (2) Year Warranty, Loader Parts Have Two (2) Year Warranty. The purchaser is solely responsible for determining suitability of goods sold. This warranty is expressly in lieu of all other warranties expressed or implied. Buhler Industries Inc. will in no event be liable for any incidental or consequential damages whatsoever. Nor for any sum in excess of the price received for the goods for which liability is claimed.

### Repair Parts Limited Warranty

Buhler Industries Inc. warrants Farm King replacement parts purchased after the expiration of the Buhler Industries Inc. Limited Warranty, and used and serviced as provided for in the Operator's Manual, to be free from defects in materials or workmanship for a period of thirty (30) days from the invoice date for the parts. Buhler Industries Inc. will fulfill this limited warranty by, at its option, repairing or replacing any covered part that is defective or is the result of improper workmanship, provided that the part is returned to Buhler Industries Inc. within thirty (30) days of the date that such defect or improper workmanship is, or should have been, discovered. Such parts must be shipped to Buhler Industries Inc. at the purchaser's expense.

### What is Not Covered

Under no circumstances does this limited warranty cover any components or parts that have been subject to the following: negligence; alteration or modification not approved by Buhler Industries Inc.; misuse; improper storage; lack of reasonable and proper maintenance, service, or repair; normal wear; damage from failure to follow operating instructions; accident; and/or repairs that have been made with parts other than those manufactured, supplied, and or authorized by Buhler Industries Inc.

**Authorized Dealer and Labor Costs**

Repairs eligible for labor under this limited warranty must be made by Buhler Industries Inc. or an authorized Farm King dealer. Buhler Industries Inc. retains the exclusive discretion to determine whether it will pay labor costs for warranty repairs or replacements, and the amount of such costs that it will pay and the time in which the repairs will be made. If Buhler Industries Inc. determines that it will pay labor costs for warranty work, it will do so by issuing a credit to the dealer's or distributor's account. Buhler Industries Inc. will not approve or pay invoices sent for repairs that Buhler Industries Inc. has not previously approved. Warranty service does not extend the original term of this limited warranty.

**Warranty Requirements**

To be covered by warranty, each Farm King new product must be registered with Buhler Industries Inc. within thirty (30) days of delivery to original retail purchaser. If the customer decides to purchase replacement components before the warranty disposition of such components is determined, Buhler Industries Inc. will bill the customer for such components and then credit the replacement invoice for those components later determined to be covered by this limited warranty. Any such replacement components that are determined not be covered by this limited warranty will be subject to the terms of the invoice and shall be paid for by the purchaser.

**Warranty Claims:**

Warranty requests must be prepared on Buhler Industries Inc. Warranty Claim Forms with all requested information properly completed. Warranty Claims must be submitted within a thirty (30) day period from date of failure repair.

**Warranty Labor:**

Any labor subject to warranty must be authorized by Buhler Industries Inc. The labor rate for replacing defective parts, where applicable, will be credited at 100% of the dealer's posted shop rate. Defective parts will receive an extra 10% discount to assist with freight or other incidental costs.

**Exclusive Effect of Warranty and Limitation of Liability**

TO THE EXTENT PERMITTED BY LAW, BUHLER INDUSTRIES INC. DISCLAIMS ANY WARRANTIES, REPRESENTATIONS, OR PROMISES, EXPRESS OR IMPLIED, AS TO THE QUALITY, PERFORMANCE, OR FREEDOM FROM DEFECT OF THE COMPONENTS AND PARTS COVERED BY THIS WARRANTY AND NOT SPECIFICALLY PROVIDED FOR HEREIN.

TO THE EXTENT PERMITTED BY LAW, BUHLER INDUSTRIES INC. DISCLAIMS ANY IMPLIED WARRANTIES OF MERCHANTABILITY AND FITNESS FOR A PARTICULAR PURPOSE ON ITS PRODUCTS COVERED HEREIN, AND DISCLAIMS ANY RELIANCE BY THE PURCHASER ON BUHLER INDUSTRIES INC.'S SKILL OR JUDGMENT TO SELECT OR FURNISH GOODS FOR ANY PARTICULAR PURPOSE. THE PURCHASER'S ONLY AND EXCLUSIVE REMEDIES IN CONNECTION WITH THE BREACH OR PERFORMANCE OF ANY WARRANTY ON PRODUCTS MANUFACTURED BY BUHLER INDUSTRIES INC. ARE THOSE SET FORTH HEREIN. IN NO EVENT SHALL BUHLER INDUSTRIES INC. BE LIABLE FOR INCIDENTAL OR CONSEQUENTIAL DAMAGES (INCLUDING, BY WAY OF EXAMPLE ONLY AND NOT LIMITATION, LOSS OF CROPS, LOSS OF PROFITS OR REVENUE, OTHER COMMERCIAL LOSSES, INCONVENIENCE, OR COST OF REPLACEMENT OF RENTAL EQUIPMENT). IN NO EVENT SHALL FARM KING'S CONTRACT OR WARRANTY LIABILITY EXCEED THE PURCHASE PRICE OF THE PRODUCT.

(Note that some provinces or states do not allow limitations on how long an implied warranty lasts or the exclusion or limitation of incidental or consequential damages, so the above limitations and exclusion may not apply to you.) This warranty gives you specific legal rights and you may also have other rights, which vary from province to province or state to state.

Buhler Industries Inc. neither assumes nor authorizes any person or entity, including its selling representatives, to assume any other obligations or liability in connections with the sale of covered equipment, or to make any other warranties, representations, or promises, express or implied, as to the quality, performance, or freedom from defect of the components and parts covered herein. No one is authorized to alter, modify, or enlarge this limited warranty, or its exclusions, limitations and reservations.

Corrections of defects and improper workmanship in the manner, and for the applicable time periods, provided for herein shall constitute fulfillment of all responsibilities of Buhler Industries Inc. to the purchaser, and Buhler Industries Inc. shall not be liable in negligence, contract, or on any other basis with respect to the subject equipment.

This limited warranty is subject to any existing conditions of supply which may directly affect Buhler Industries Inc.'s ability to obtain materials or manufacture replacement parts.

Buhler Industries Inc. reserves the right to make improvements in design or changes in specifications to its products at anytime, without incurring any obligation to owners of units previously sold.

**Government Legislation:**

Warranty terms and conditions are subject to provincial or state legislation.

**Important Note:** This warranty does not apply to rentals.



[www.farm-king.com](http://www.farm-king.com)



1330 43rd Street NW  
Fargo, ND USA 58102  
Ph.: 701.282.7014 | Fax: 701.282.5865  
Toll Free: 888.524.1004  
E-mail: [info@buhler.com](mailto:info@buhler.com)  
[www.farm-king.com](http://www.farm-king.com)

Equipment shown is subject to change without notice.  
©2010 Buhler Trading Inc. Printed in USA. TSX:BUI

**bühler** | a division of Buhler Industries Inc.